

Connecting Your Macbook to the WiFi

*** If you have connected to the Capital network before, please remove any old profile configurations by going to **System Settings > Privacy and Security > Profiles**. Click into the Capital profile and click the **minus sign** to remove. Enter your computer password if prompted to confirm the change. Then proceed with steps below. ***

- 1)
 - o Click **wireless** icon or enter settings and select **Wi-Fi**
 - o Click to join **Capital-GetConnected**
 - o You will see you are connected to “Capital-GetConnected”
 - o It is normal to see “No Internet” or “Unsecured Network”

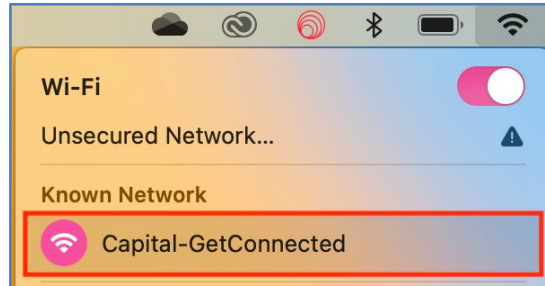

- 2)
 - o Open **Safari**
 - o **NOT Google Chrome or other browser**
 - o Enter **wifi.capital.edu** into the URL bar and hit enter
 - o If you see “This Connection Is Not Private” page tap **Show Details**

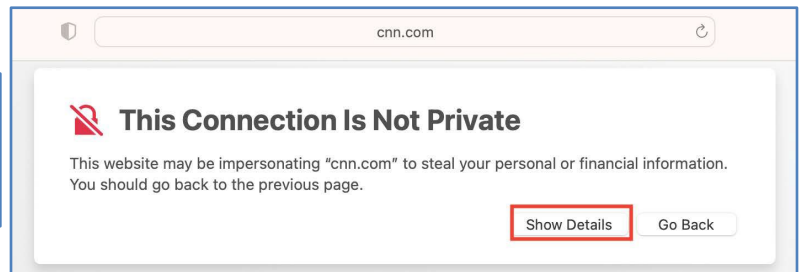
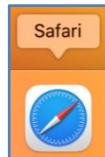

- o Click **visit this website**
- o Click **Visit Website** to continue

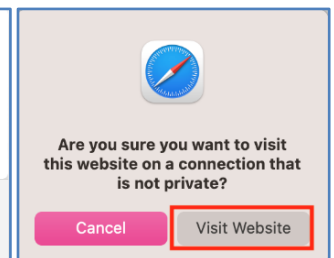
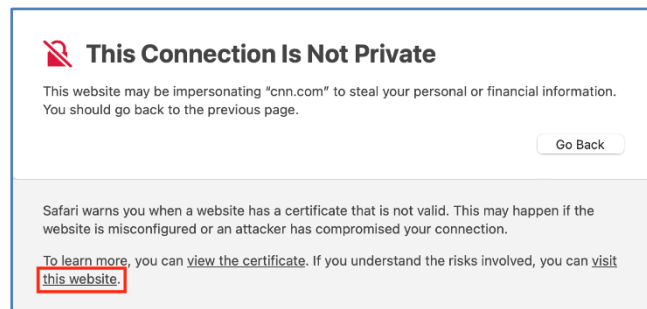

- 3)
 - o Enter your Capital **username and password**
 - o Username first part of email without @capital.edu
 - o Password same as email
 - o **Check the box** to accept the acceptable use policy
 - o Click **sign in**
 - o Select correct network
Students: **Capital-StudentPC**
Faculty/Staff: **Capital-FacStaff**

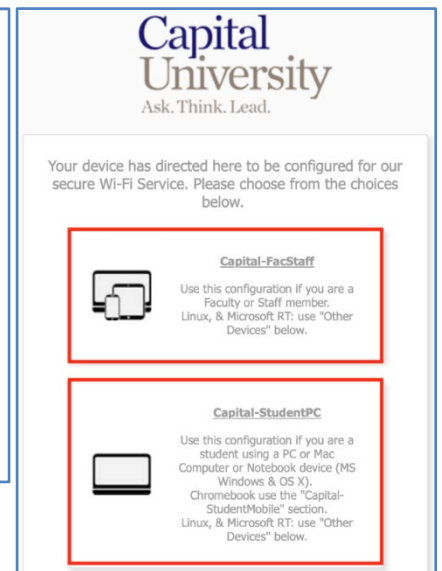
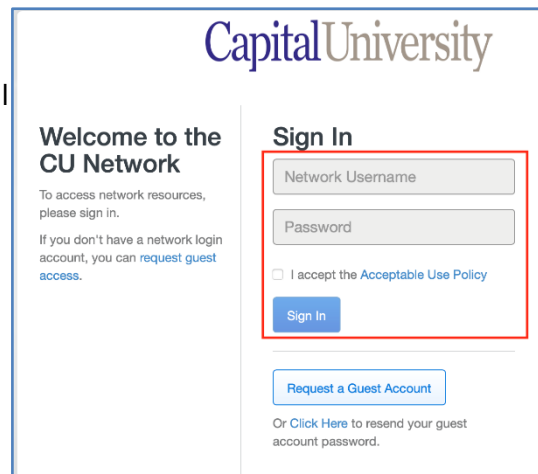

- 4)
- Click **JoinNow**
 - Click **Allow** to install the SecureW2 client

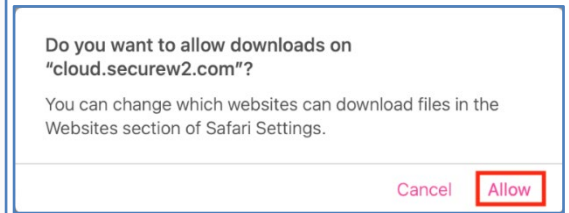
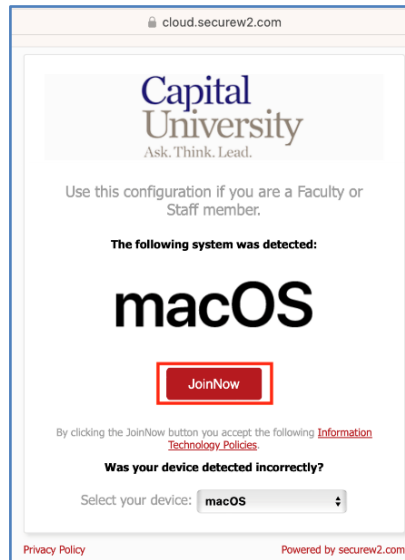

- Click **downloads icon**
- Click to **run**
- Double-click **SecureW2 icon** to open client

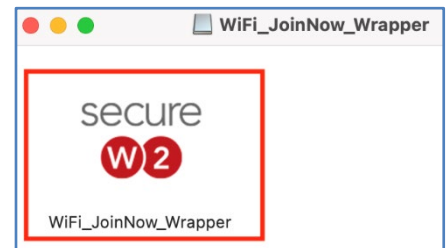
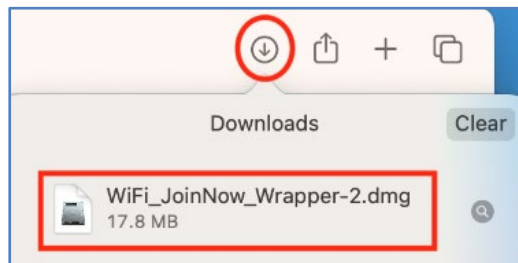

- 5)
- Click **Open**
 - Enter Capital **username and password** (same as above)
 - Click **Next**

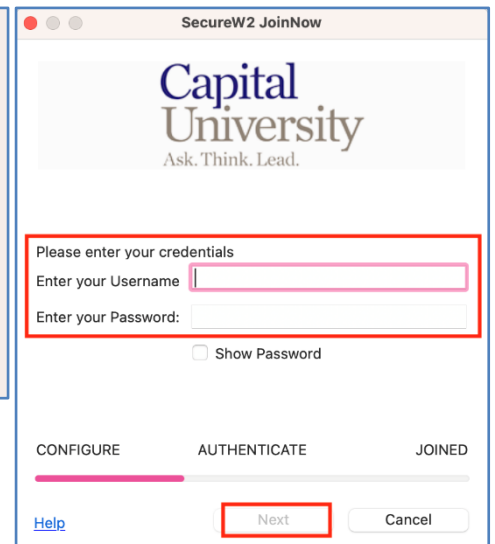
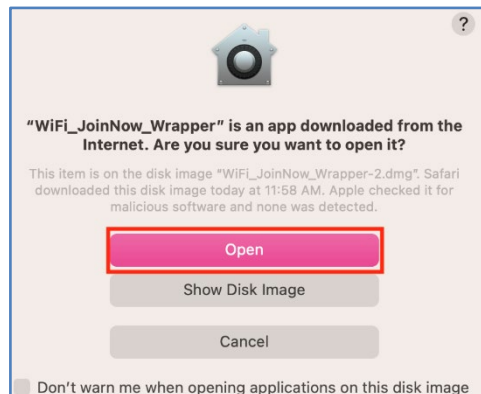

- Enter **computer password**
- Click **Next**

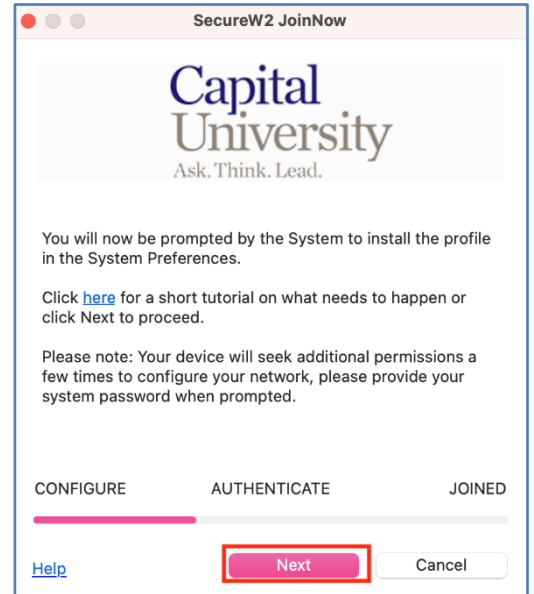
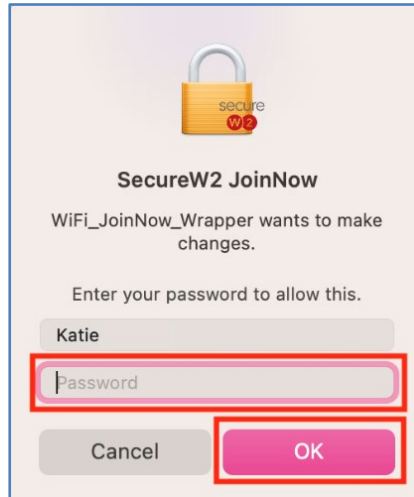

- 6) ○ Double click the Capital Profile

NOTE: If the Profiles page does not open automatically, navigate to:

Settings > Privacy & Security > Profiles

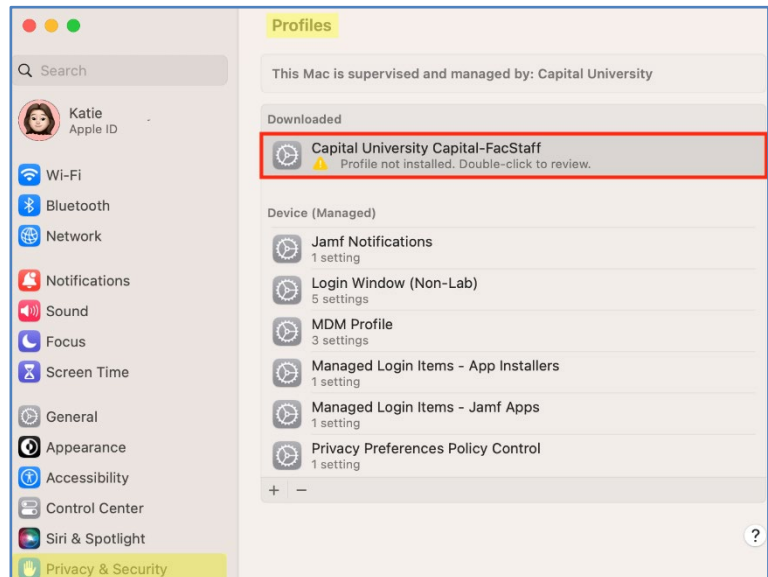

- Click **Install**
- Click **Install** again

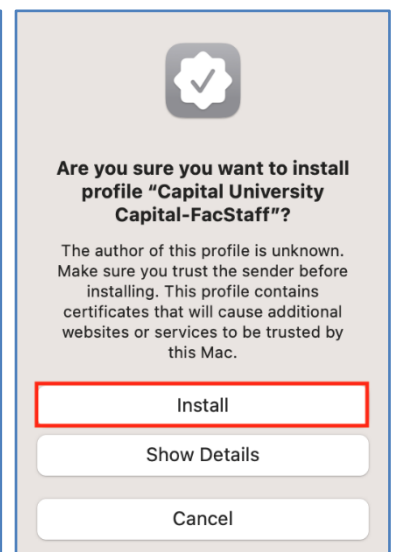
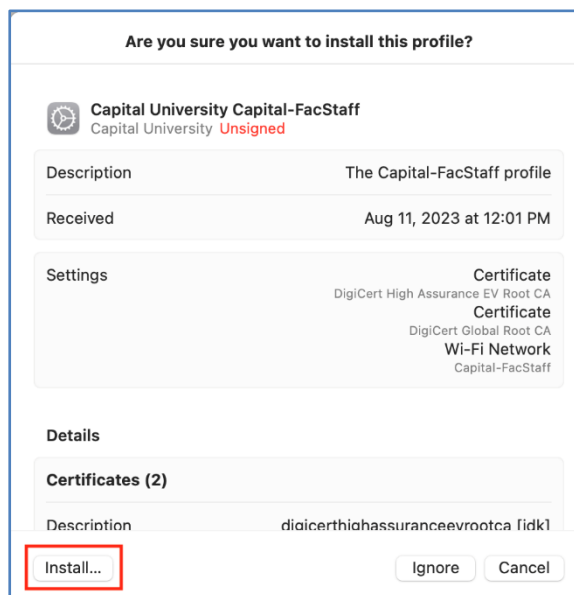

- Enter **computer password**
- Enter **computer password** again and click **Always Allow**

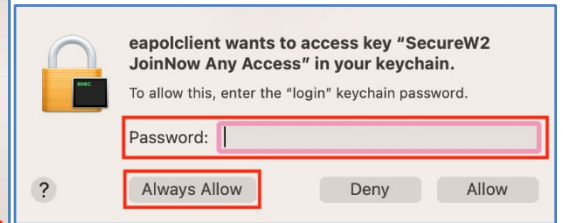
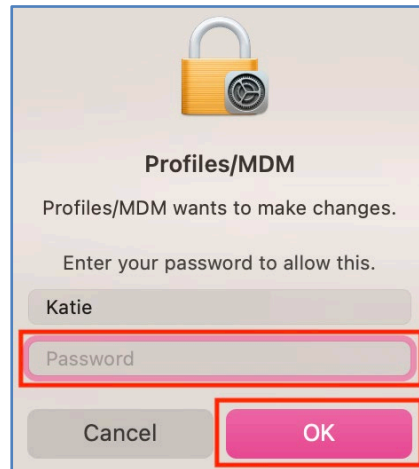

- 7)
- Reopen **Safari**
 - Try to load a **non-google webpage** such as **cnn.com**, **espn.com**, etc.
 - You may need to try multiple sites
 - Click **Download Now** to install Policy Key

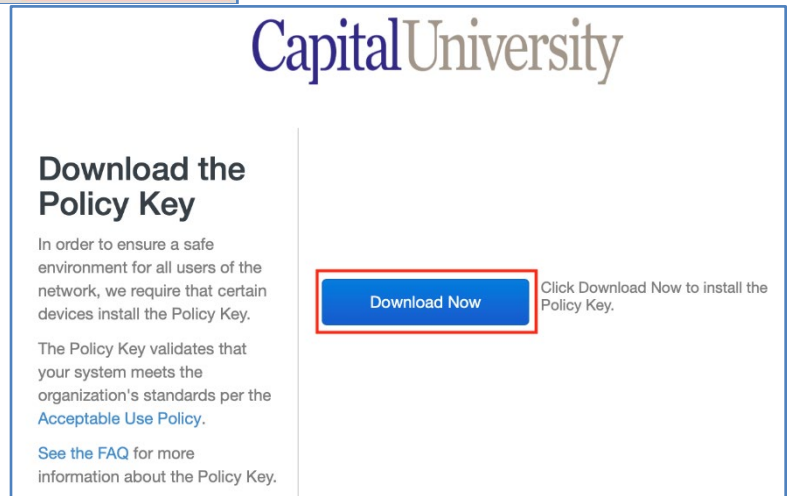
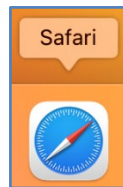

- Click **Allow**
- Click **downloads icon**
- Click to **run**

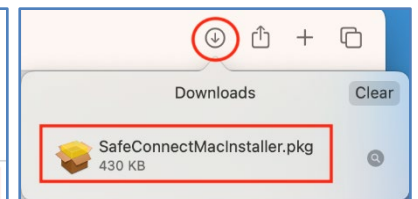
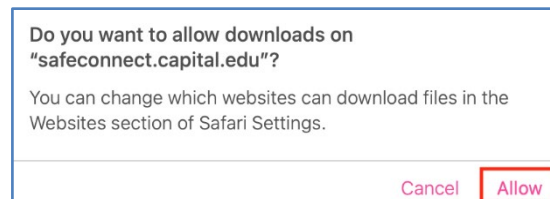

- Click **Continue**

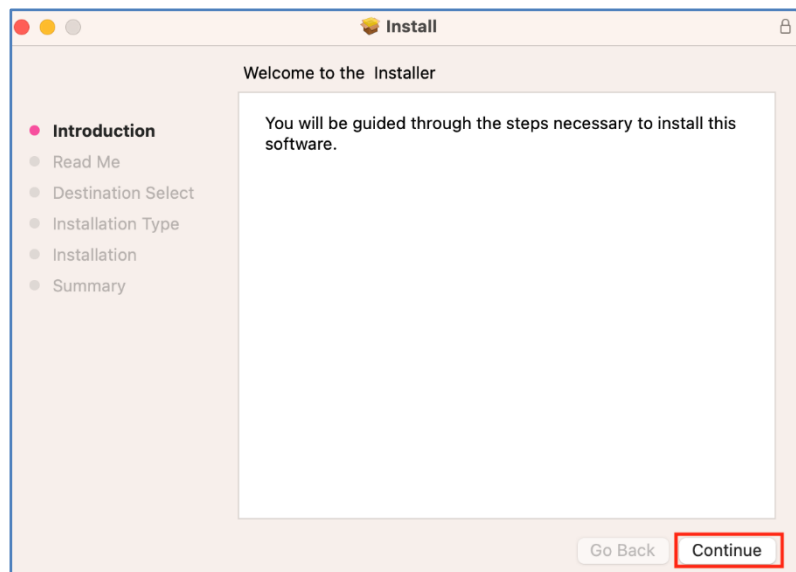

- Click **Continue**

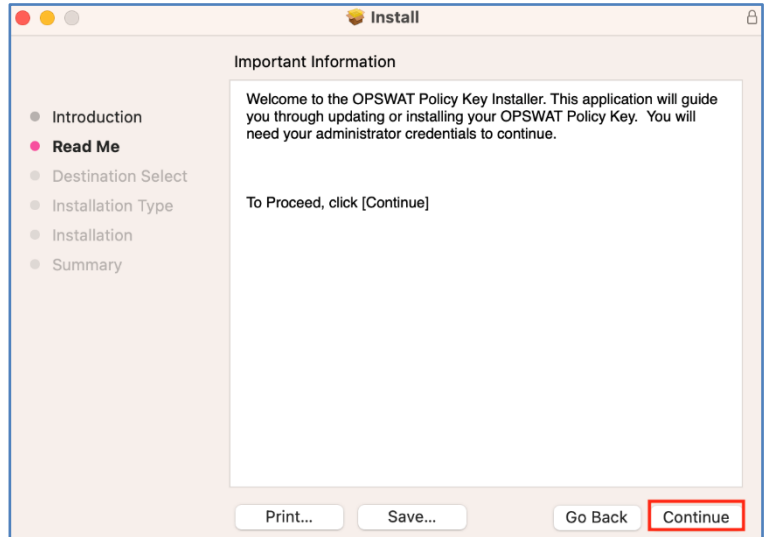

- Click **Install**

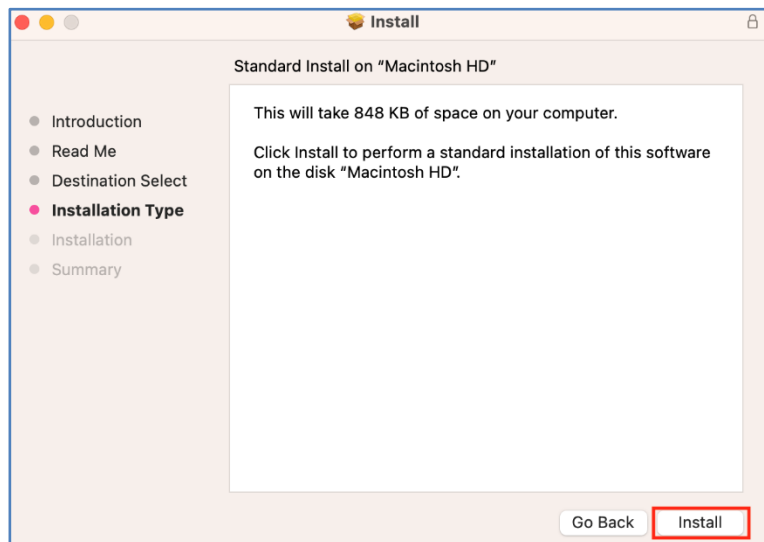

- Enter **computer password**
- Click **OK**

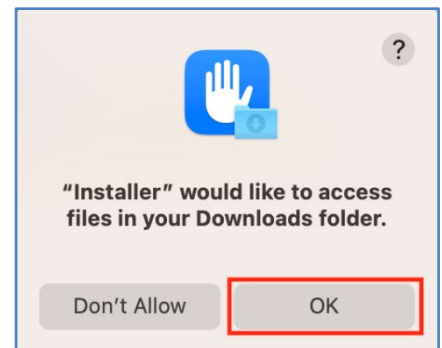
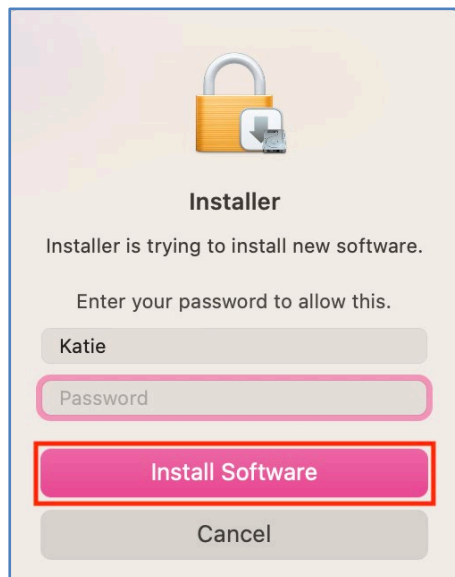

- Click **Close**

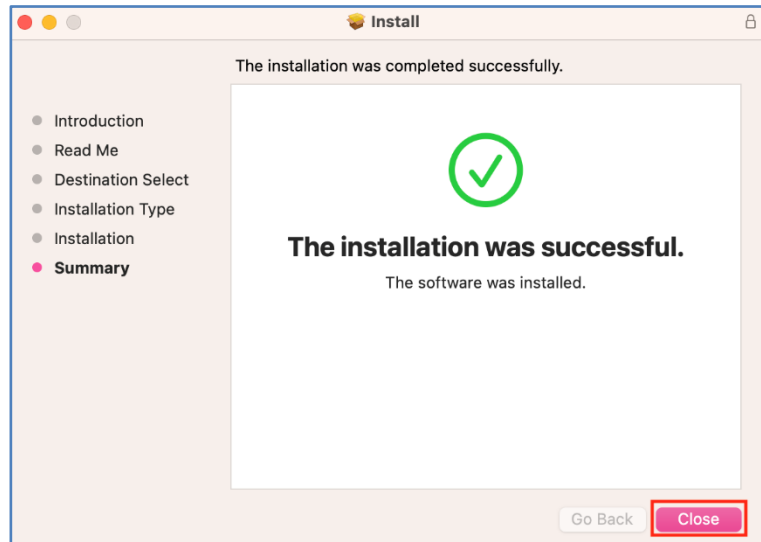

- Click **Move to Trash**

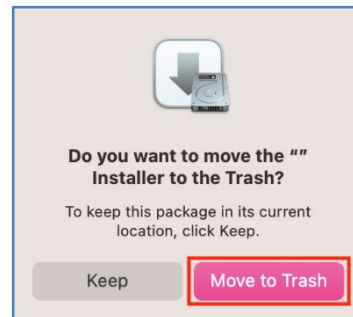

- In Safari, click **I'm done installing**

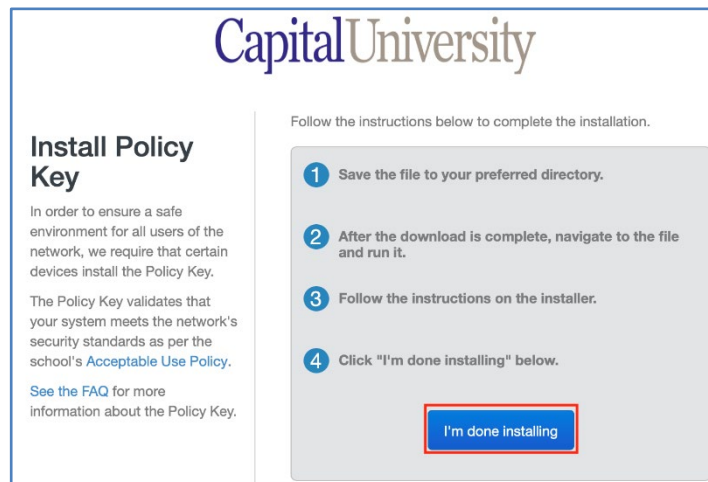

- ✓ You are now connected! Verify you are on either the Capital-StudentPC or Capital-FacStaff network and test your connection.